

### KIRK ALLEY

#### OBSERVATION:

Kirk Alley from Jefferson Street to Market Street could be a special intimate arts enclave.

#### DISCUSSION:

Kirk Alley is a unique in that people working downtown consider it a walking street, an intimate shortcut. The design team wanted to see if tinkering with Kirk Alley just a bit without making it too homogenized would make this experience even better.

The proposal was to extend public areas into the existing parking lot behind the Lunsford Insurance building as part of its expansion and redevelopment. This would provide an expansive lawn area for people watching rock climbers rappelling down the back wall of Mill Mountain Theatre. Another option is to use the area for an intimate art film festival by projecting films on the blank wall. The idea is not to make Kirk Alley a big space, but to give it a charming European quality.

Subsequent meetings with the property owners yielded little hope for the success of this idea. The

design team, however, believes the idea should be open to consideration since the surrounding commercial property is underutilized. It would appear to be only a matter of time before redevelopment transforms these buildings.

There is also an idea for retaining the little landscaped lot at the Chamber of Commerce. The design team proposes to screen the blank wall of the City Market Square Parking Garage by constructing a building for a small restaurant similar to the one at Paley Park in New York. Then the existing landscaped park could be redesigned to become more of a tree-shaded urban plaza for dining instead of a suburban landscape with shrubs and walking paths.

#### FINDINGS:

- Expand Century Plaza into the parking lot behind Lunsford Insurance to create a multi-use lawn area. This can be studied as part of a redevelopment program for the building in the future.
- Renovate the pocket park at Jefferson Street and Kirk Alley as an urban plaza with a small building for active retail (restaurant) masking the blank wall of the parking garage.



*Kirk Alley could become a special intimate arts enclave.*



*The small pocket park at the corner of Jefferson Street and Kirk Alley should be more of an urban plaza where people can gather.*



*If the large wall was taken out, the parking lot could be converted into an extension of the plaza and become an outdoor seating lawn to watch movies projected on the side of the building.*

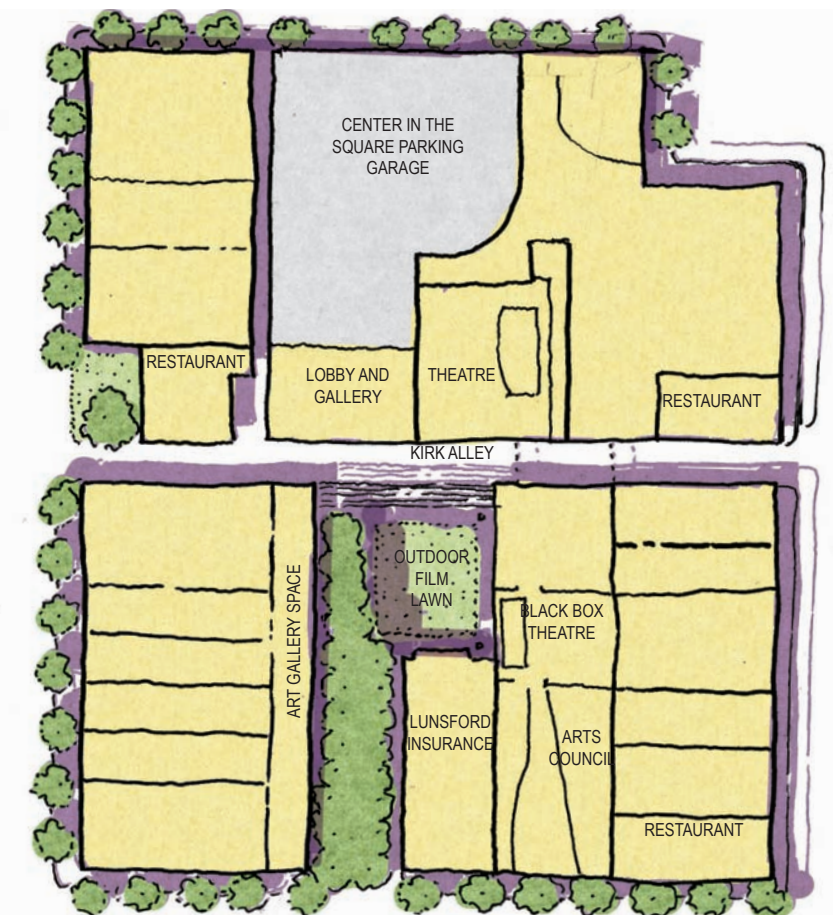

*Diagram of Use*



*Existing handicap ramp and stairs into the plaza could become more graceful as small, full length steps that also serve as seating.*